

**NEW** Lens  **connect**

## RF Series

1" 20 MEGA PIXEL FIXED FOCAL REMOTE CONTROL LENS



Model No.	Format	Focal Length	F No.	Working Distance	Weight
VL0826U-MPZ	1"	8mm	F2.6	0.1m-Inf.	334g
VL1226U-MPZ		12mm	F2.6	0.1m-Inf.	273g
VL1624U-MPZ		16mm	F2.4	0.1m-Inf.	280g
VL2520U-MPZ		25mm	F2.0	0.15m-Inf.	257g
VL3522U-MPZ		35mm	F2.2	0.2m-Inf.	313g
VL5024U-MPZ		50mm	F2.4	0.2m-Inf.	326g
VL7531U-MPZ		75mm	F3.1	0.25m-Inf.	415g

**VL0826U-MPZ**

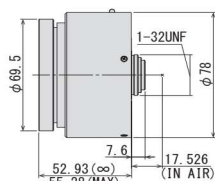

**VL1226U-MPZ**

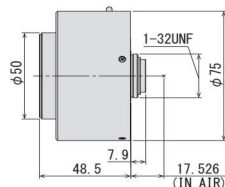

**VL1624U-MPZ**

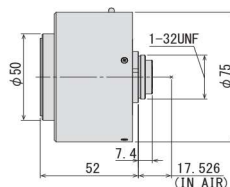

**VL2520U-MPZ**

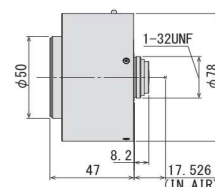

Focal Length		8mm						12mm						16mm						25mm					
Max. Aperture Ratio		1:2.6						1:2.6						1:2.4						1:2.0					
Max. Image Format		12.8mm × 9.6mm( ϕ 16mm)						12.8mm × 9.6mm( ϕ 16mm)						12.8mm × 9.6mm( ϕ 16mm)						12.8mm × 9.6mm( ϕ 16mm)					
Operation Range	Iris	F2.6 - F16.0						F2.6 - F16.0						F2.4 - F16.0						F2.0 - F16.0					
	Focus	0.1m - Inf.						0.1m - Inf.						0.1m - Inf.						0.15m - Inf.					
Control	Iris	Motorized						Motorized						Motorized						Motorized					
	Focus	Motorized						Motorized						Motorized						Motorized					
Angle of View	D	1"	88.8°	2/3"	68.6°	1/1.8"	58.2°	1"	67.4°	2/3"	49.8°	1/1.8"	41.5°	1"	53.2°	2/3"	38.1°	1/1.8"	31.6°	1"	35.5°	2/3"	24.9°	1/1.8"	20.5°
	H		76.9°		57.1°		47.8°		56.7°		40.7°		33.7°		43.8°		30.9°		25.5°		28.8°		20.0°		16.4°
	V		61.5°		44.2°		36.6°		44.1°		31.0°		25.5°		33.6°		23.4°		19.2°		21.8°		15.1°		12.4°
Operating Temperature		-10° C ~ +50° C						-10° C ~ +50° C						-10° C ~ +50° C						-10° C ~ +50° C					

Optical Distortion	1"	-0.8%	2/3"	-2.1%	1/1.8"	-1.9%	1"	0.0%	2/3"	-1.1%	1/1.8"	-1.0%	1"	0.0%	2/3"	-0.4%	1/1.8"	-0.4%	1"	0.0%	2/3"	0.0%	1/1.8"	0.0%
Back Focal Length	10.6mm (In Air)						10.6mm (In Air)						10.7mm (In Air)						9.1mm (In Air)					
Flange Back Length	17.526mm (In Air)						17.526mm (In Air)						17.526mm (In Air)						17.526mm (In Air)					
Mount	C-Mount						C-Mount						C-Mount						C-Mount					
Filter Size	M82 P=0.75mm (With ZM0810)*						M46 P=0.75mm						M43 P=0.75mm						M46 P=0.75mm					
Weight	334g						273g						280g						257g					

Control Interface	USB2.0					USB2.0					USB2.0					USB2.0				
Power mode	Bus powerd (500mA)					Bus powerd (500mA)					Bus powerd (500mA)					Bus powerd (500mA)				
Connector	USB TypeA					USB TypeA					USB TypeA					USB TypeA				

\*When using filters, lens requires VM0810 (sold separately).

# 1" 20 MEGA PIXEL FIXED FOCAL REMOTE CONTROL LENS

- Motorized FA lens that can be operated easily with a single USB cable
- Focus and Iris can be controlled via USB
- Ultra-high resolution lens, suitable for 1" 20 megapixel sensor
- Much lower distortion design for all models is beneficial for a variety of machine vision applications
- Has the newest optical design, which has a much higher relative illuminance compared to conventional models, despite having a large format 1" sensor (Ø16mm)

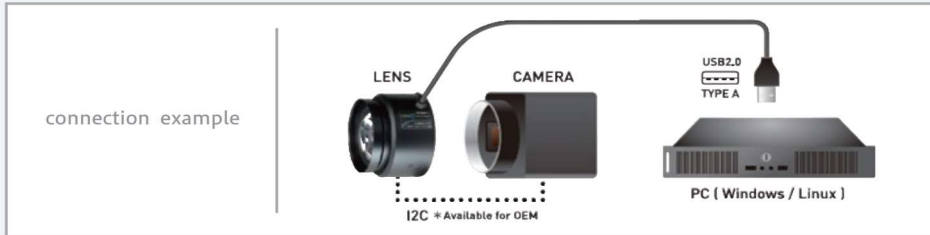
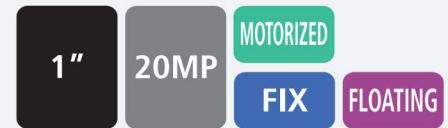

## VL3522U-MPZ

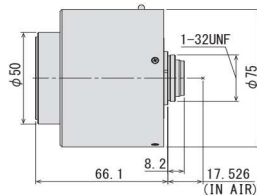

## VL5024U-MPZ

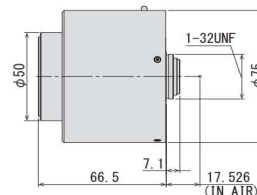

## VL7531U-MPZ

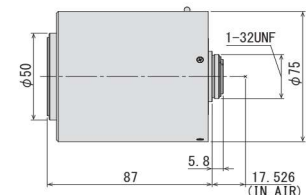

Focal Length		35mm						50mm						75mm					
Max. Aperture Ratio		1:2.2						1:2.4						1:3.1					
Max. Image Format		12.8mm × 9.6mm( ϕ 16mm)						12.8mm × 9.6mm( ϕ 16mm)						12.8mm × 9.6mm( ϕ 16mm)					
Operation Range	Iris	F2.2 - F16.0						F2.4 - F16.0						F3.1 - F16.0					
	Focus	0.2m - Inf.						0.2m - Inf.						0.25m - Inf.					
Control	Iris	Motorized						Motorized						Motorized					
	Focus	Motorized						Motorized						Motorized					
Angle of View	D	1"	25.8°	2/3"	17.9°	1/1.8"	14.7°	1"	18.2°	2/3"	12.6°	1/1.8"	10.3°	1"	12.2°	2/3"	8.4°	1/1.8"	6.9°
	H		20.8°		14.4°		11.8°		14.6°		10.1°		8.3°		9.8°		6.7°		5.5°
	V		15.7°		10.8°		8.9°		11.0°		7.6°		6.2°		7.3°		5.0°		4.1°
Operating Temperature		-10° C ~ +50° C						-10° C ~ +50° C						-10° C ~ +50° C					

Optical Distortion	1"	0.0%	2/3"	0.0%	1/1.8"	0.0%	1"	0.0%	2/3"	0.0%	1/1.8"	0.0%	1"	0.0%	2/3"	0.0%	1/1.8"	0.0%
Back Focal Length	9.7mm (In Air)						11.1mm (In Air)						12.0mm (In Air)					
Flange Back Length	17.526mm (In Air)						17.526mm (In Air)						17.526mm (In Air)					
Mount	C-Mount						C-Mount						C-Mount					
Filter Size	M43 P=0.75mm						M43 P=0.75mm						M43 P=0.75mm					
Weight	313g						326g						415g					

Control Interface	USB2.0						USB2.0						USB2.0					
Power mode	Bus powerd (500mA)						Bus powerd (500mA)						Bus powerd (500mA)					
Connector	USB TypeA						USB TypeA						USB TypeA					